

Iso-Flex® Dura-Block Expansion Joint System

PRODUCT DESCRIPTION

The Iso-Flex Dura-Block expansion joint system consists of a mechanically anchored, steel reinforced EPDM anchor block with an EPDM rubber seal profile.

BASIC USES

Iso-Flex Dura-Block expansion joint is a rugged system that is appropriate for use in bridges, elevated roadways, parking decks and other vehicular applications where heavy volume is expected.

ADVANTAGES

- The system is capable of accommodating heavy vehicular traffic.
- The basic seal profile allows for usage in high movement areas.
- Having a complete rubber traffic surface creates a very low noise surface, particularly in hard-wheeled applications such as with tow motors.
- Has excellent weatherability.

LIMITATIONS

- Performance of the Iso-Flex Dura-Block expansion joint is closely tied to preparation and installation techniques as well as structural behavior of the expansion joint gap. Maintaining close tolerances is essential to the success of the expansion joint system. Correct installation of this system is critical and should be performed only by an authorized applicator of products manufactured by LymTal International, Inc.

STANDARD COLORS

Black

INSTALLATION

Preliminary: Blockouts to receive the Iso-Flex Dura-Block expansion joints must be clean, dry, sound, relatively smooth and free of voids, ridges, and sharp projections. Joint openings and blockouts must be properly sized.

Preparation: Using a standard anchor block as a template locate and drill the anchor locations. With the anchor holes drilled, install the anchor system and blow the blockout clean.

Installation: With the substrate prepared begin by applying the elastomeric bedding compound to the blockout base. Insert and install the EPDM seal profile into the joint gap and press into the bedding material. Locate the anchor blocks over the profile and torque down anchors.

PRECAUTIONS

Refer to Material Safety Data Sheet for detailed health and safety information prior to use.

WARRANTY

LymTal warrants that its products are manufactured free of defects and conform to the technical data listed. Under this warranty we will replace, at no charge, any material proven defective when applied in accordance with our written instructions for applications recommended by us as suitable for subject product. LymTal shall not be liable for any injury, loss or damage, direct or consequential, arising out of the use of the product.

TECHNICAL DATA FROM LABORATORY TESTS		
EPDM Rubber Profile & Anchor Panel		
Property	Test Method	Test Results
Tensile Strength	ASTM D412	1500 psi min.
Elongation @ Break	ASTM D412	200% min
Hardness (Shore A)	ASTM D2240	50 min.
Compression Set (Method B)	ASTM D395	25% max.
Ozone Resistance	ASTM D1149	No Cracks
Low Temp Flexibility	ASTM D2137	Pass (140°F.)
Bond During Vulcanization	ASTM D429	80% R.

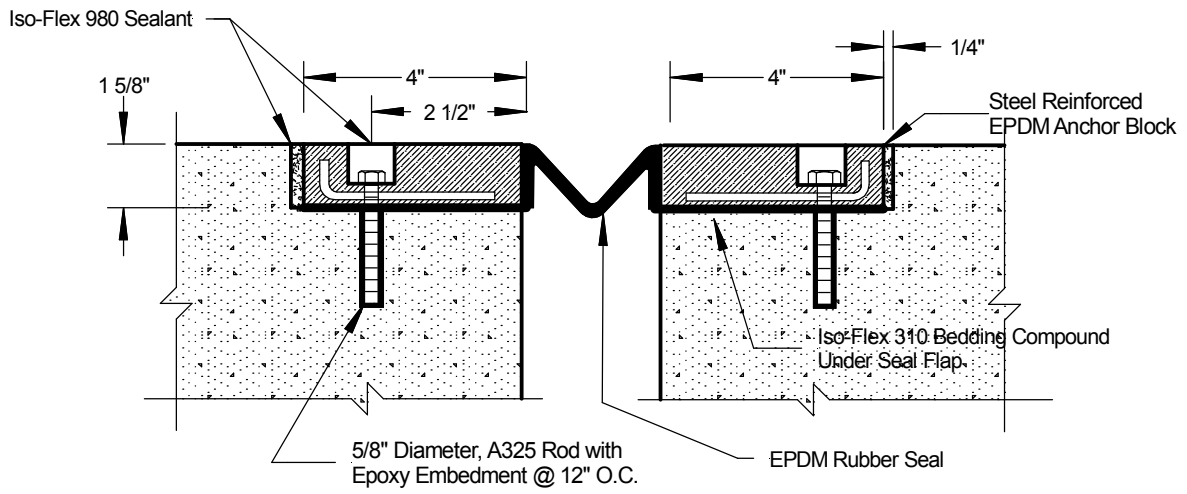

Revised 2/05